

## Stage 1

### SPECIFICATIONS

**SQUARE FOOTAGE:**

12,000SF

**CEILING HEIGHT:**

35' Clear, 10'x10' grid

**POWER:**

1,600 AMPS | 3 Phase

**HEAT / AIR:**

Silent Air - 80 Tons

**ACOUSTICS:**

NC 30

**FLOORING:**

Sealed Concrete

**CONNECTION:**

20' Elephant Door to Stage 2

**UTILITIES:**

Water connection

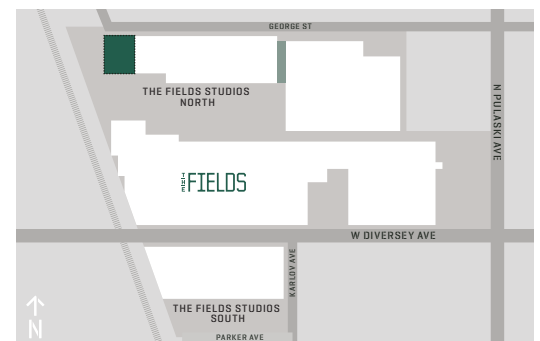
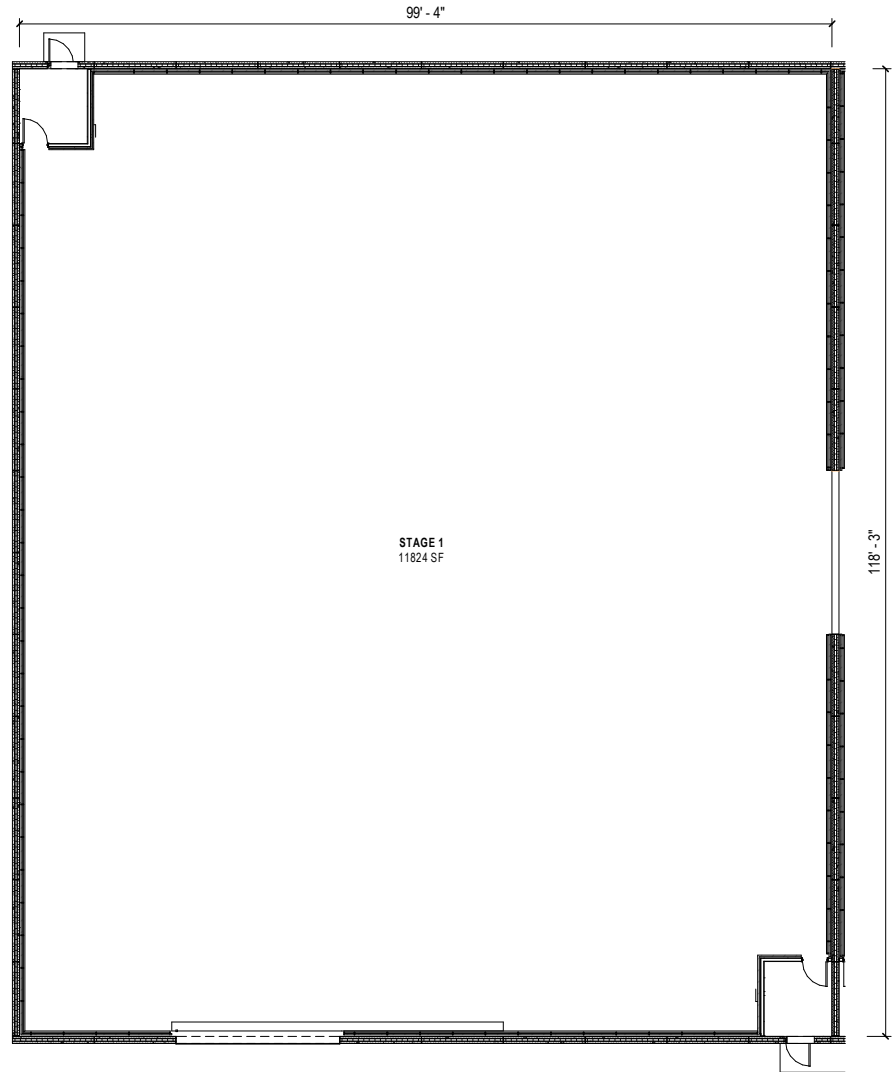

## Stage 2

### SPECIFICATIONS

**SQUARE FOOTAGE:**

12,000SF

**CEILING HEIGHT:**

35' Clear, 10'x10' grid

**POWER:**

1,600 AMPS | 3 Phase

**HEAT / AIR:**

Silent Air - 80 Tons

**ACOUSTICS:**

NC 30

**FLOORING:**

Sealed Concrete

**CONNECTION:**

20' Elephant Door to Stage 1

**UTILITIES:**

Water connection

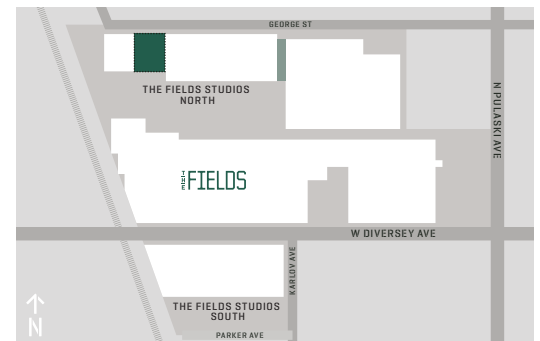
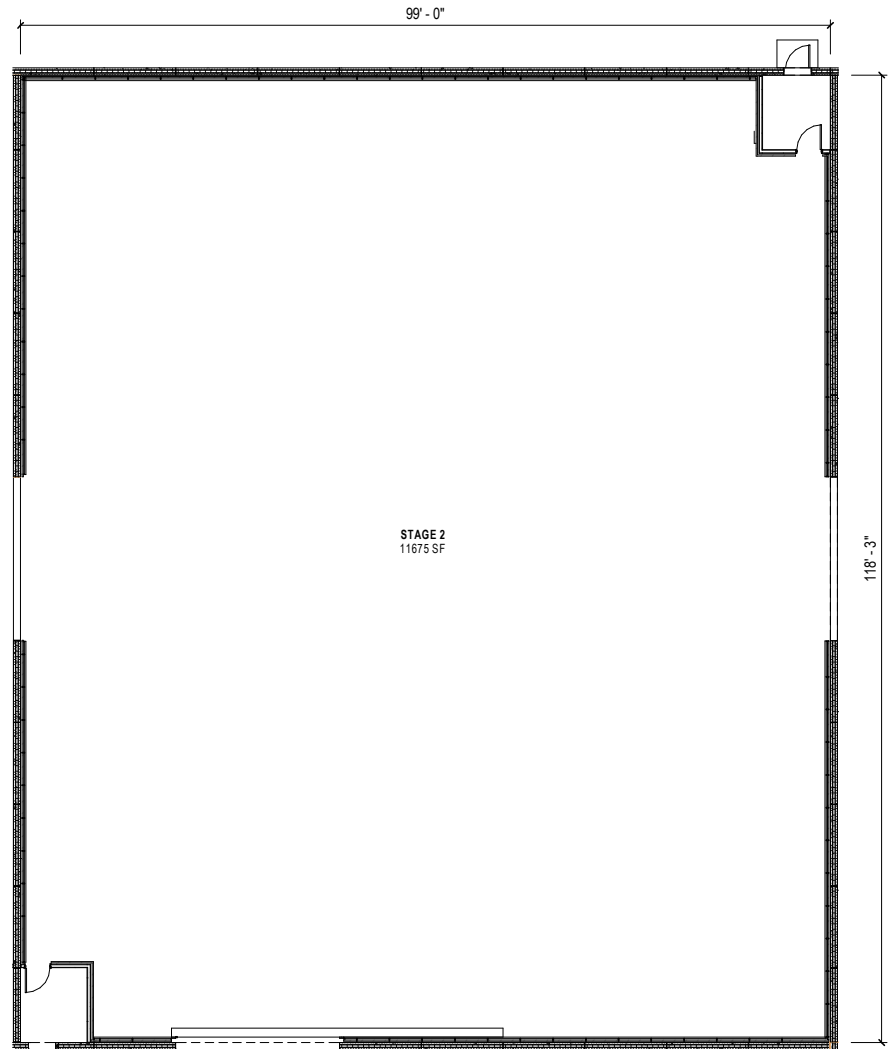

## Stage 3

### SPECIFICATIONS

**SQUARE FOOTAGE:**

18,000SF

**CEILING HEIGHT:**

35' Clear, 10'x10' grid

**POWER:**

3,000 AMPS | 3 Phase

**HEAT / AIR:**

Silent Air - 120 Tons

**ACOUSTICS:**

NC 30

**FLOORING:**

Sealed Concrete

**UTILITIES:**

Water connection

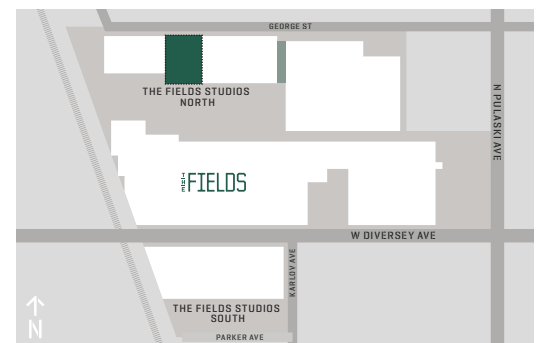
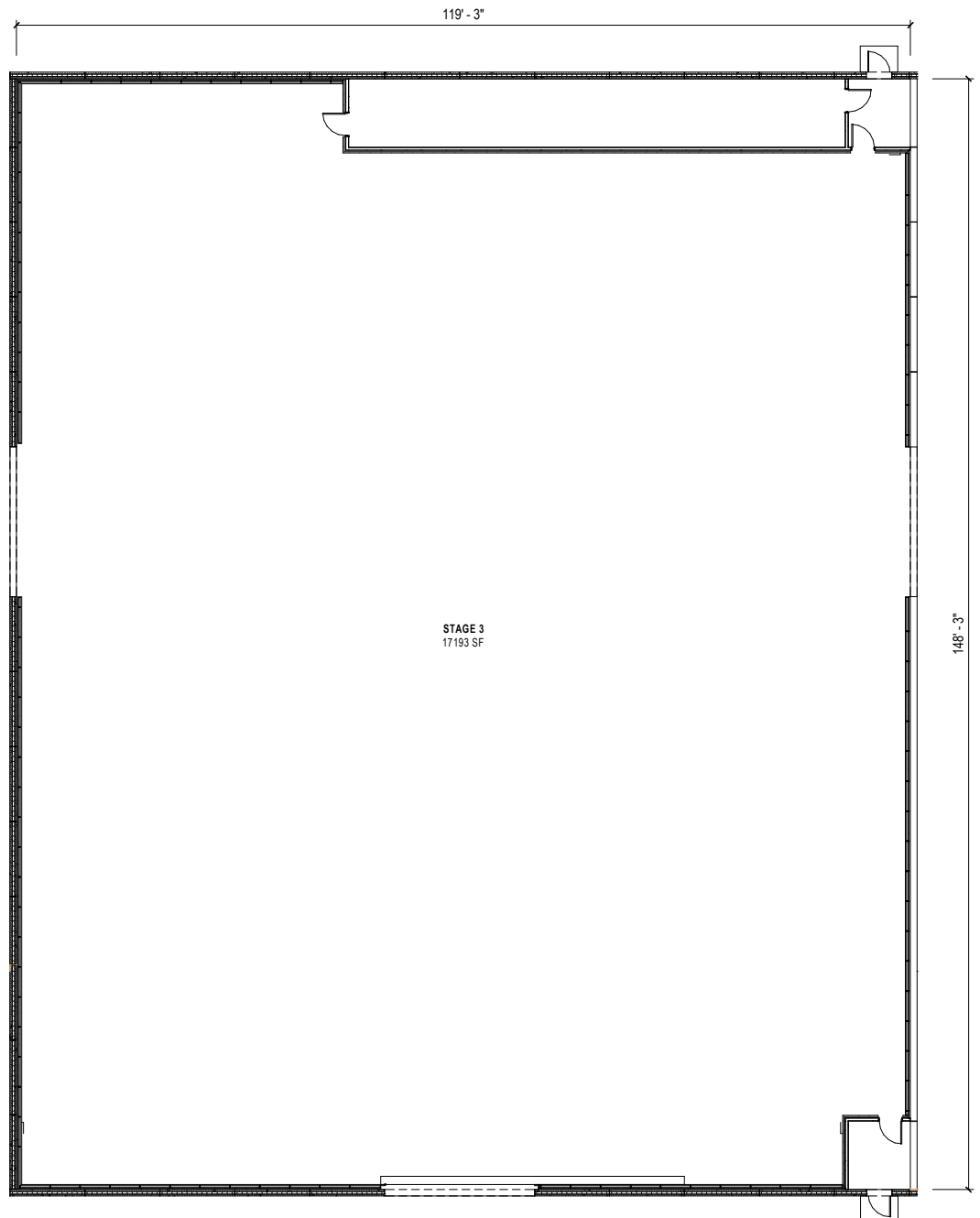

## Stage 4

### SPECIFICATIONS

**SQUARE FOOTAGE:**

18,000SF

**CEILING HEIGHT:**

35' Clear, 10'x10' grid

**POWER:**

3,000 AMPS | 3 Phase

**HEAT / AIR:**

Silent Air - 120 Tons

**ACOUSTICS:**

NC 30

**FLOORING:**

Sealed Concrete

**CONNECTION:**

Fully Operable Wall to Studio 5

**UTILITIES:**

Water connection

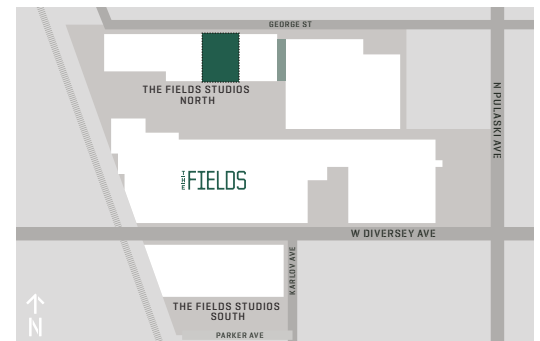
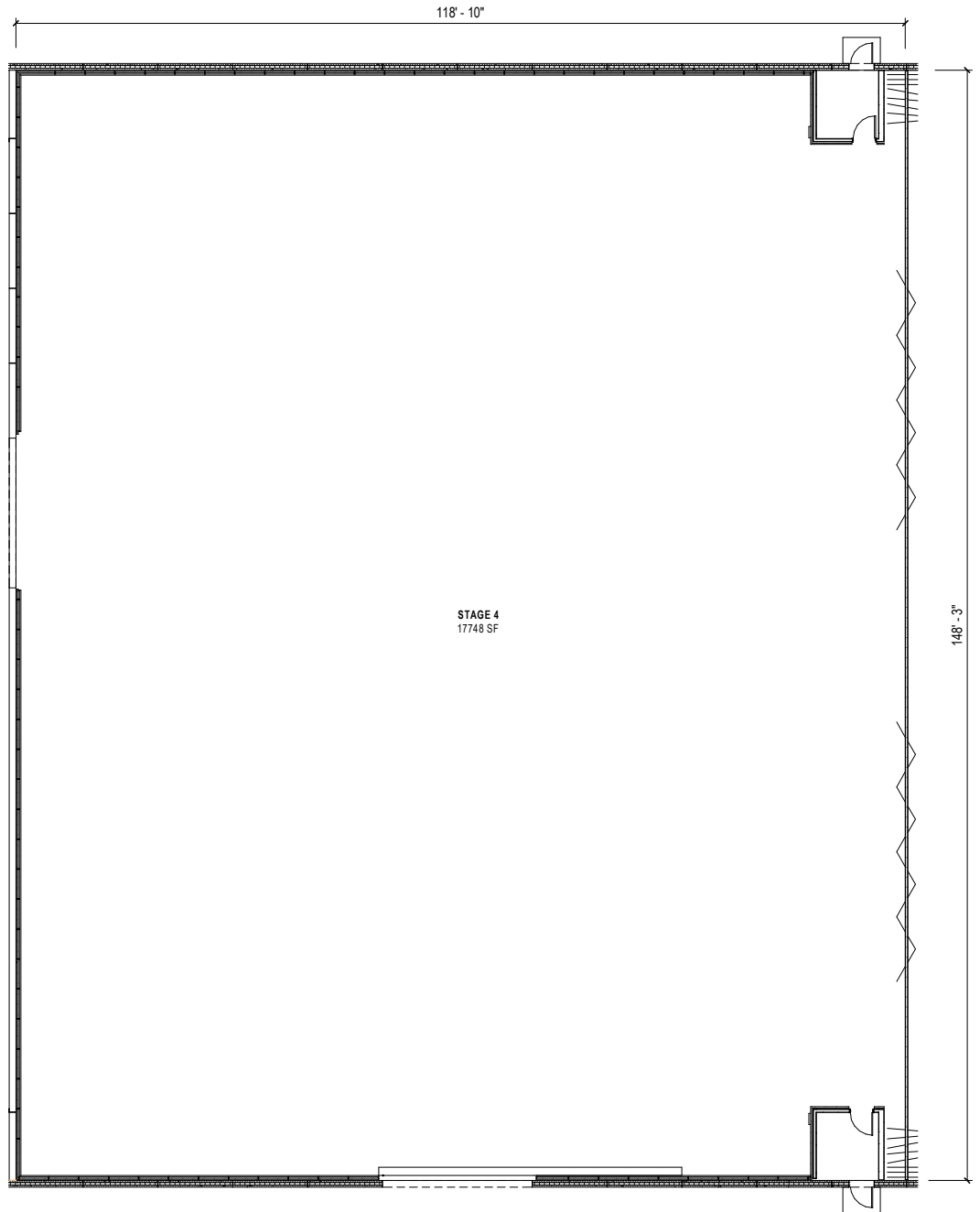

## Stage 5

### SPECIFICATIONS

**SQUARE FOOTAGE:**

18,000SF

**CEILING HEIGHT:**

35' Clear, 10'x10' grid

**POWER:**

3,000 AMPS | 3 Phase

**HEAT / AIR:**

Silent Air - 120 Tons

**ACOUSTICS:**

NC 30

**FLOORING:**

Sealed Concrete

**CONNECTION:**

Fully Operable Wall to Studio 4

**UTILITIES:**

Water connection

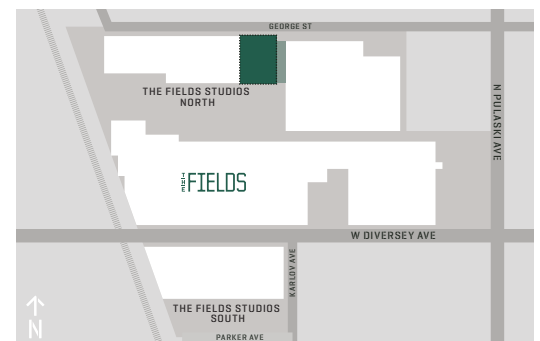
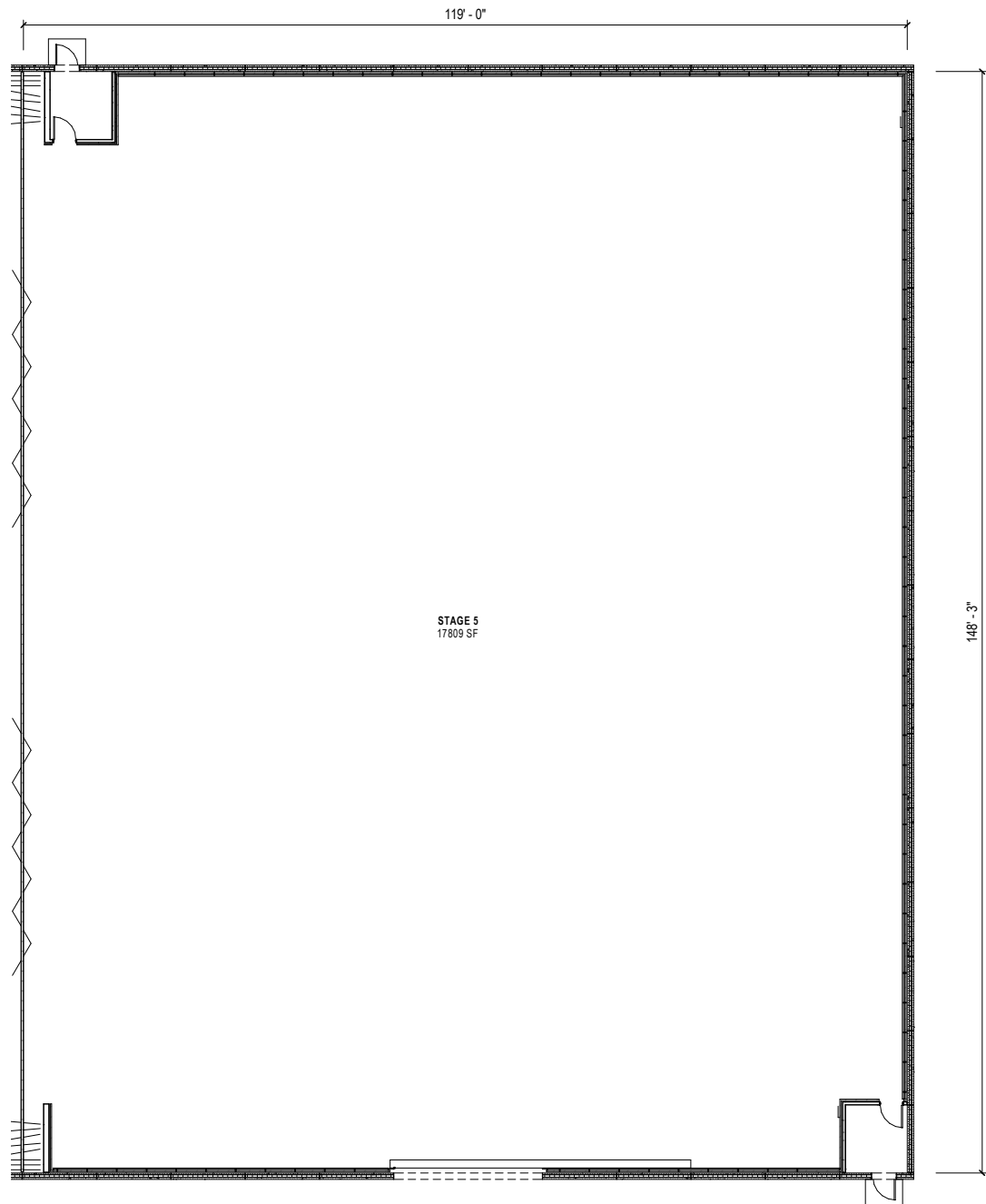

## Stage 6

### SPECIFICATIONS

**SQUARE FOOTAGE:**

18,000SF

**CEILING HEIGHT:**

35' Clear, 10'x10' grid

**POWER:**

3,000 AMPS | 3 Phase

**HEAT / AIR:**

Silent Air - 120 Tons

**ACOUSTICS:**

NC 30

**FLOORING:**

Sealed Concrete

**CONNECTION:**

Fully Operable Wall to Studio 7

**UTILITIES:**

Water connection

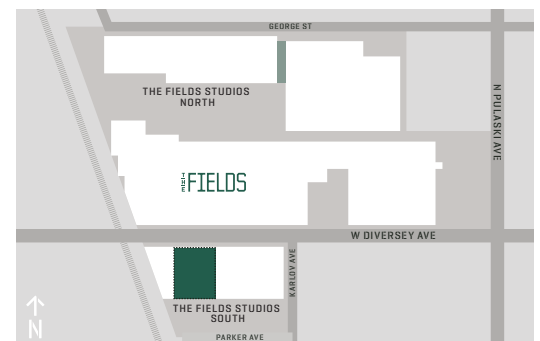
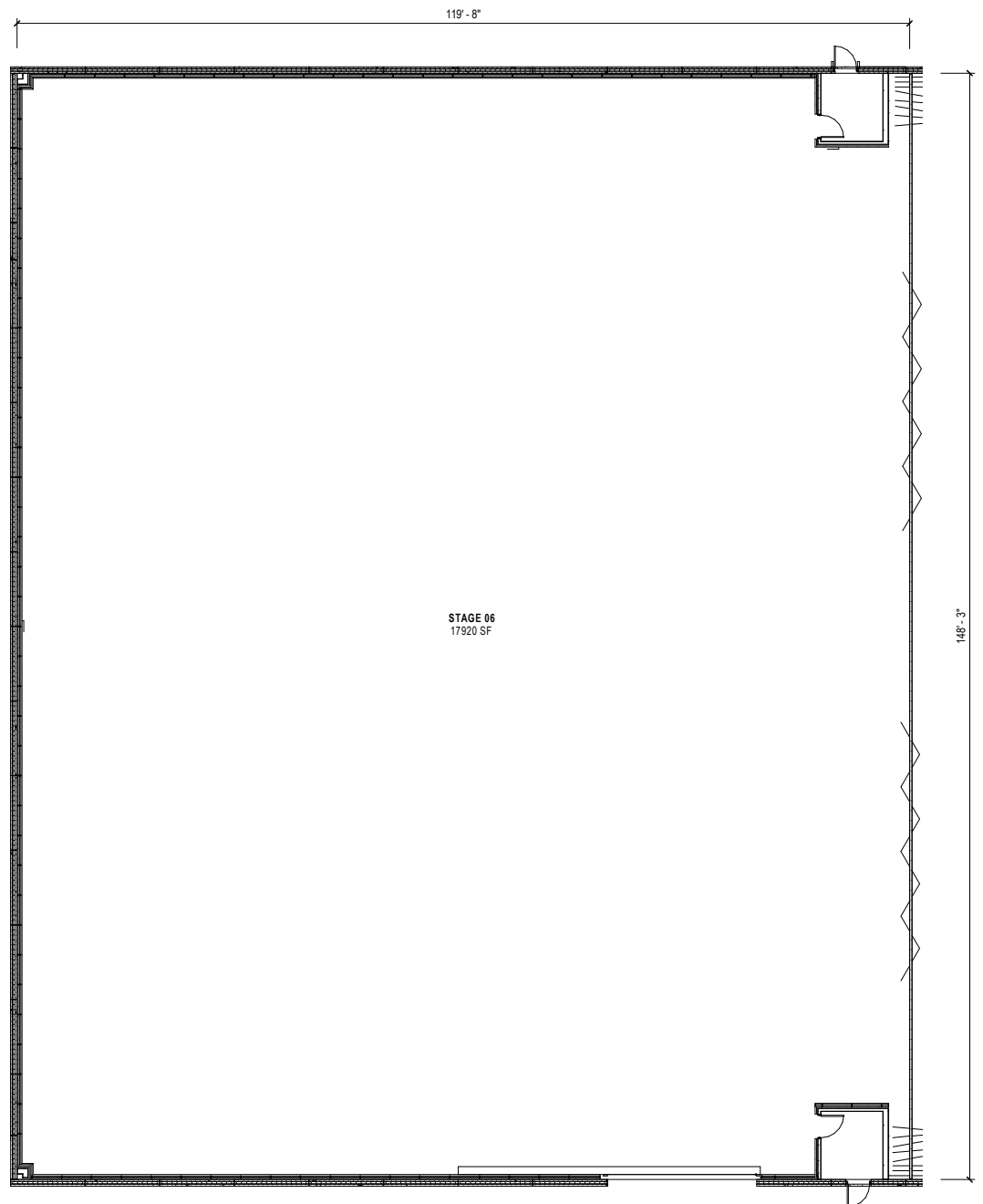

## Stage 7

### SPECIFICATIONS

**SQUARE FOOTAGE:**

18,000SF

**CEILING HEIGHT:**

35' Clear, 10'x10' grid

**POWER:**

3,000 AMPS | 3 Phase

**HEAT / AIR:**

Silent Air - 120 Tons

**ACOUSTICS:**

NC 30

**FLOORING:**

Sealed Concrete

**CONNECTION:**

Fully Operable Wall to Studio 6

**UTILITIES:**

Water connection

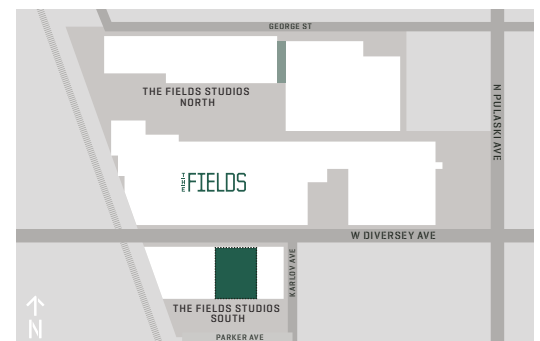
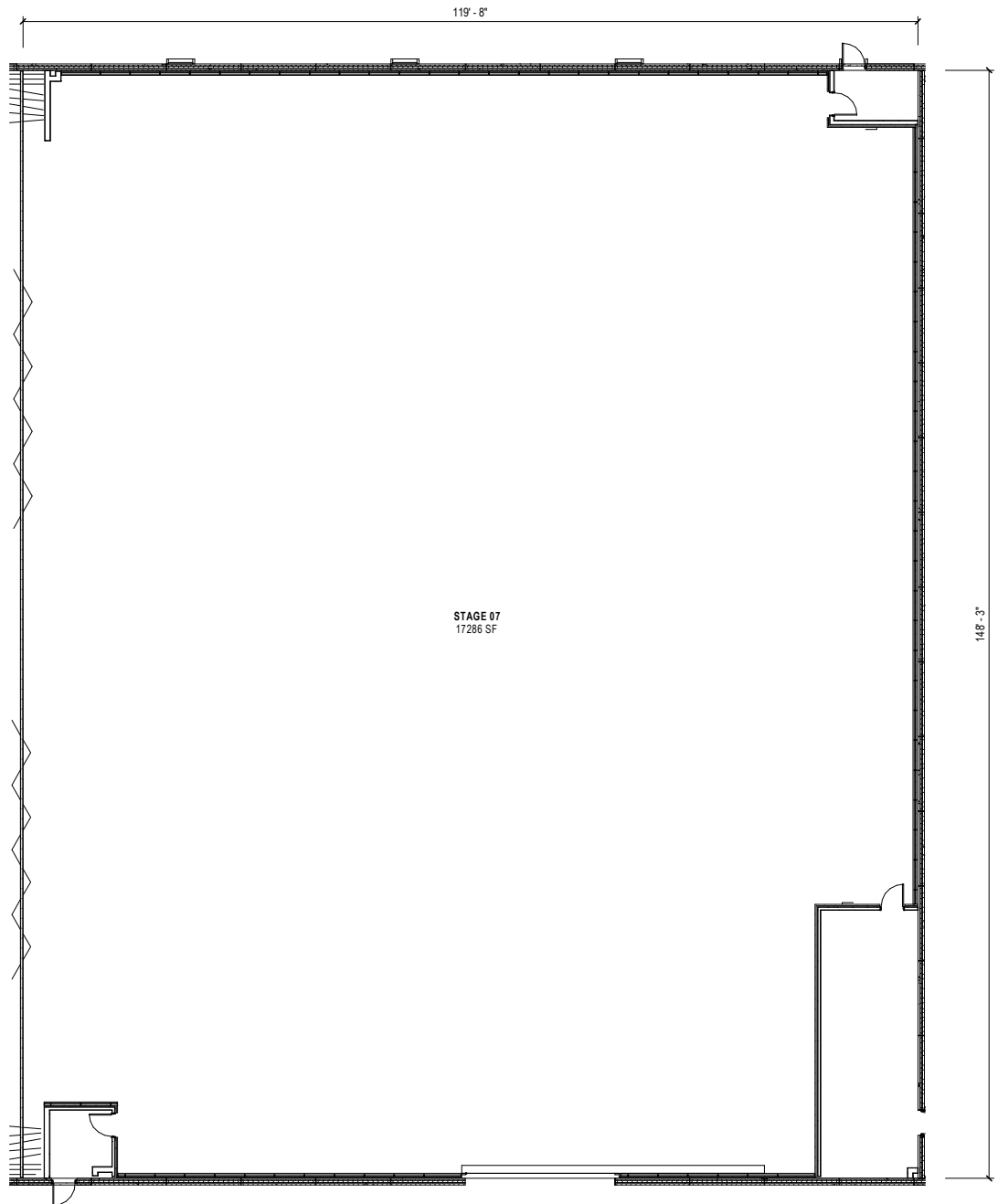

## Stage 8

### SPECIFICATIONS

**SQUARE FOOTAGE:**

18,000SF

**CEILING HEIGHT:**

35' Clear, 10'x10' grid

**POWER:**

3,000 AMPS | 3 Phase

**HEAT / AIR:**

Silent Air - 120 Tons

**ACOUSTICS:**

NC 30

**FLOORING:**

Sealed Concrete

**UTILITIES:**

Water connection

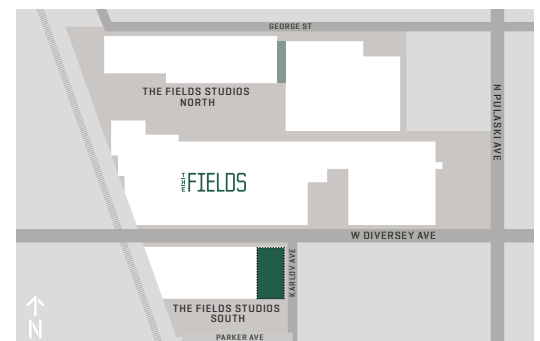
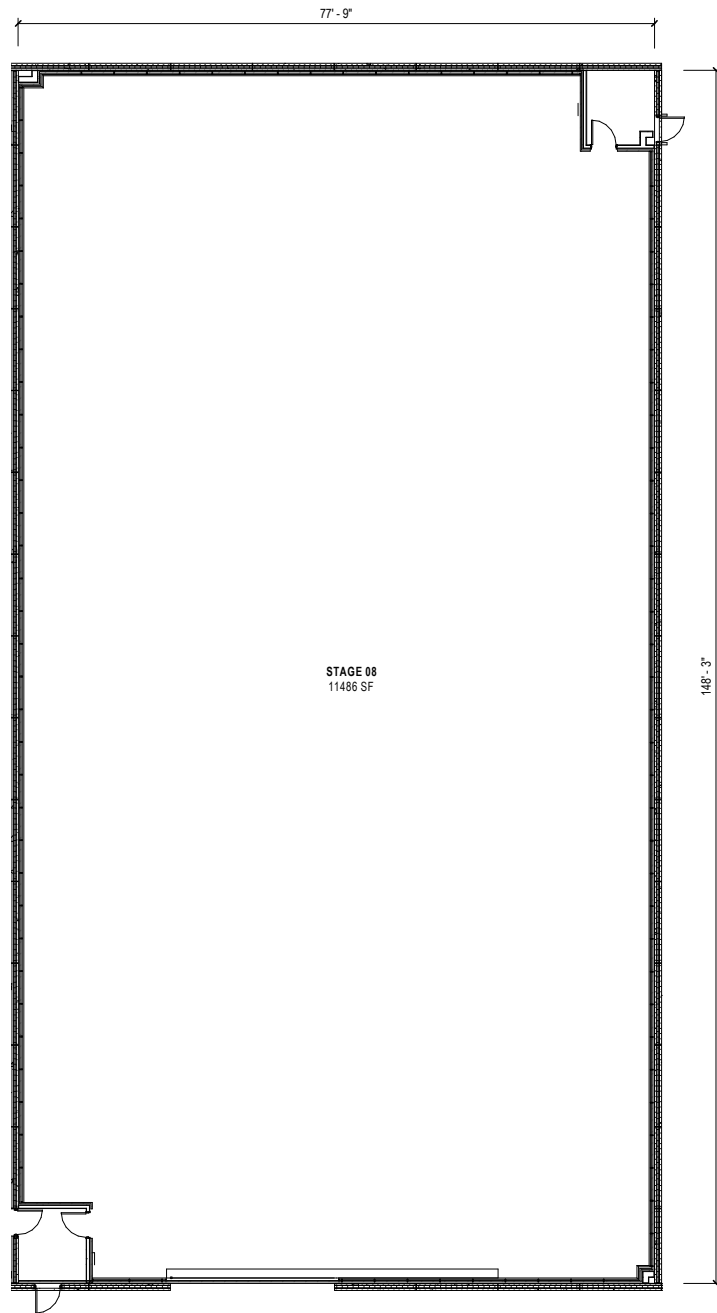



# THE FIELDS | STUDIOS

## Stage 9

### SPECIFICATIONS

**SQUARE FOOTAGE:**

5,000SF

**CEILING HEIGHT:**

22' Clear, freestanding truss

**POWER:**

800 AMPS | 3 Phase

**FLOORING:**

Sealed Concrete

**AMENITIES:**

Private offices and dressing rooms, private entrance and restrooms

